

LANGUAGE: ENGLISH



GRILLZ

SMOKEHOUSE

INSTRUCTION MANUAL



Wolf International Ltd
Suite 1, 284 Warley Hill, Great Warley,
Brentwood, Essex. CM13 3AB
Tel: + 44 (0)333 366 8888
Email: support@wolfint.co.uk
Web: www.wolfint.co.uk

GRILLZ SMOKEHOUSE INSTRUCTION MANUAL

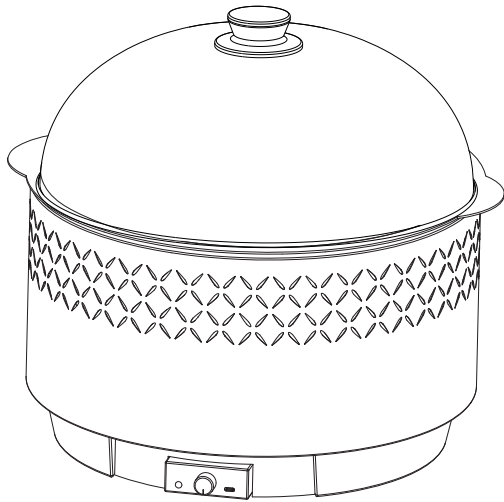

This product can ONLY be used OUTDOORS in a ventilated environment, NEVER use it indoors as burning charcoal can cause carbon monoxide poisoning.

Do not leave excessive combustible gel (solid alcohol) on the Gel container. There are potential risks of burning the fan box and other parts.

SPECIFICATIONS

- Easy and quick start with the smart turbo fan.
- Cast Iron Grill Rack
- No dripping fat or seasoning on the charcoal with the unique charcoal box design
- Portable product for transportation and storage.
- Easy to clean parts.

PRECAUTIONS

- **DO NOT** use the product indoors.
- **DO NOT** leave children and pets unattended while using grill.
- **DO NOT** block the air vent on the main body.
- Keep the product on a flat surface during use.
- **DO NOT** touch the grill rack during use.

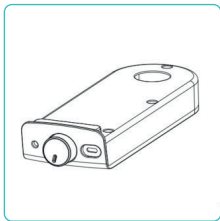
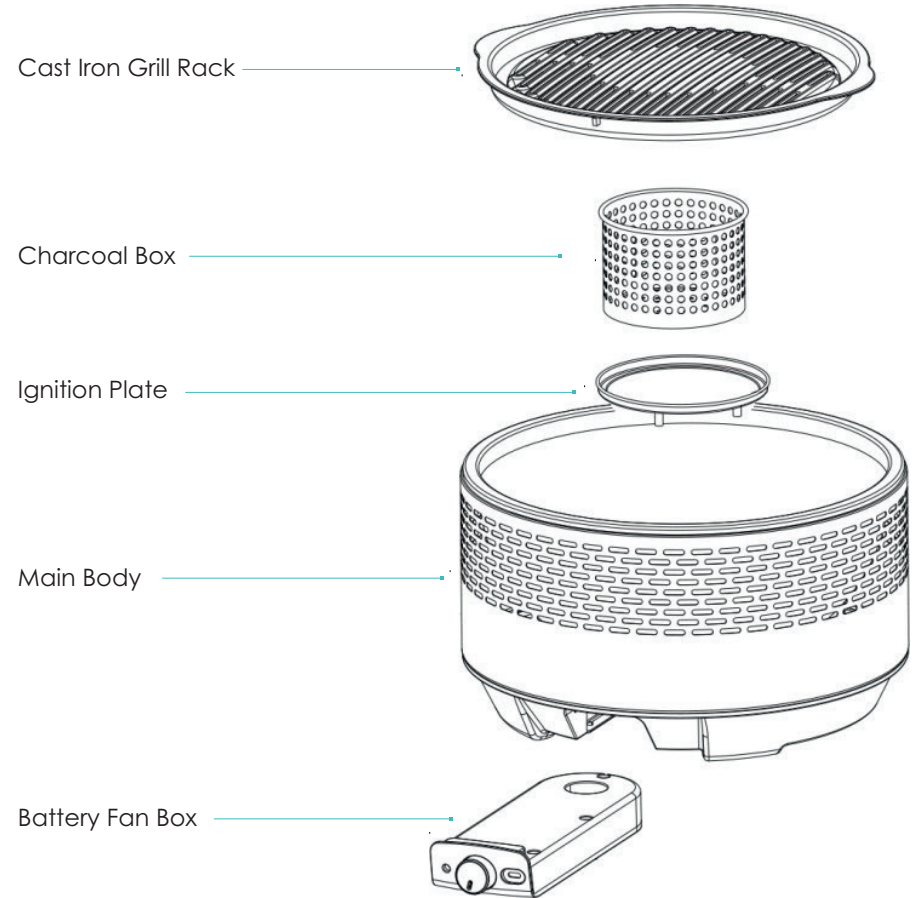

1 Put 4 x AA batteries inside the Fan Box.

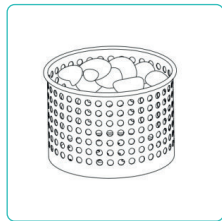

2 Fill the Charcoal Box with sufficient charcoal.

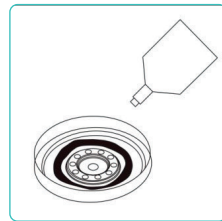

3 Add solid fuel (firelighters) on the ignition plate.

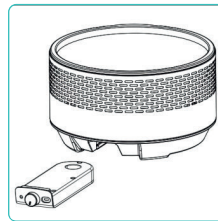

4 Insert the battery fan box into the plastic base.

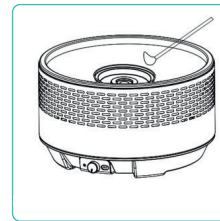

5 Light the solid fuel.

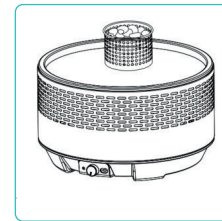

6 Place the ignition plate on the charcoal box.

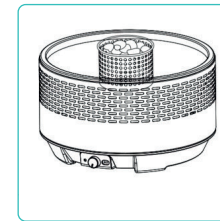

7 Turn the knob to the maximum level.



8 Put the grill rack on top of the main body.